

6GN80-8 – Brass Angle Hose Valve

SKU: 6GN80-8

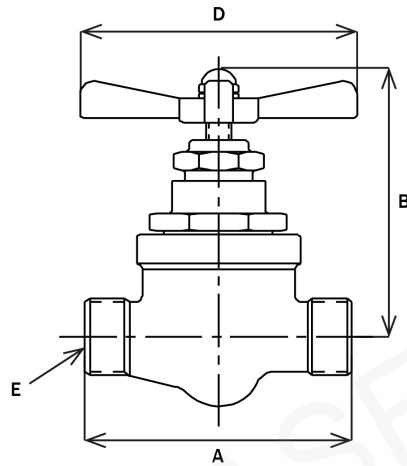

Description

- Water, oil, and gas service Material: Bronze body Normal Temperature Range: -20°F to +230°F Union nuts and tailpieces provide sil-braze, socket weld, butt weld, male/female straight and pipe thread connections. Centerline of valve stem is angled approximately 12° from the perpendicular to the piping for 1-1/2 and 2 inch pipe sizes.

Specification Table

pa_approx-dimension-b-closed-in	'10-3/8
approx_dimension_b_open_in	'11-3/8
pa_approx-dimension-d-in	'14
pa_cpv-o-seal	'480
Material	Bronze Body
pa_references	Technical Products Valves & Accessories Valve Information for TECH-O-SEAL Valves (Catalog 1220).pdf
pa_thread-size-e	'3-3/4"-12