

A-ADP-SW-6FS-8F – 6? Split Clamp to 8? Flange

SKU: A-ADP-SW-6FS-8F

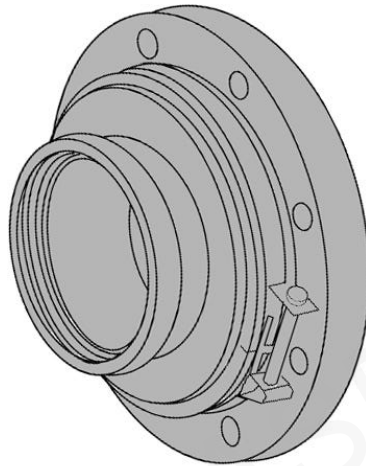

Description

- The modified swivel flange adapter connects 6? male split clamp end fittings to 150 pound ANSI flanges. The advantage of this type of adapter is that the same nipple can be used to make flange connections in multiple sizes. A modified split clamp is used to secure the flange to the nipple, and is included in the assembly. A regular aluminum split clamp is used to provide the 6? connection to another fitting. The aluminum split clamp is not included in the assembly.

Specification Table

| | |
|------------------------|----------|
| c | 11.750 |
| d | 0.88 |
| pa_female-clamp-end-in | 6 |
| drawing_number | C22370 |
| Material | Aluminum |